

TRACKWAY® ACCESS

TOGETHER WE CAN JOURNEY ANYWHERE



A TRUSTED HERITAGE

FAUN Trackway Limited has a prestigious reputation, with over 75 years' experience in the design and manufacture of premium products and tailored solutions.

Originally Saunders-Roe based on the Isle of Wight, we relocated to Anglesey during WWII, and later in 1968, we became Laird (Anglesey) Ltd. In 1996, we were acquired by the KIRCHHOFF Group; an innovative, family-run, German group of engineering and manufacturing companies that have been providing innovative solutions for over 220 years.

Our highly skilled and experienced team continue to design and manufacture ground stabilisation Trackway® products for access solutions; and, as the global leader, our systems are now in use all over the globe.

www.fauntrackway.co.uk



Making Sustainable Tracks with 100% Recyclable Trackway®





KEEPING YOU MOVING

We offer a versatile roadway, marine access, and aircraft recovery product range for an array of industries including; Oil & Gas, Construction, Forestry, and Mining; where plant and vehicle access is required within infrastructure projects and other operations. Our durable Trackway® panels are renowned for their quality, and can tackle challenging terrains such as; marsh, mud, sand, verges and river fordings.

For further information on any of our Trackway® Kits, please see our Technical Information Booklets.



Rapidly Deployed



Minimal Manpower



Multi-purpose



Protects Environments



Lightweight



Durable





MAKING SUSTAINABLE TRACKS

Designed to minimise environmental damage, the quality of our manufacturing techniques mean our Trackway® panels have a long w and are 100% recyclable. Significantly more hard-wearing than plastic alternatives which need to be frequently changed, our aluminium reduce ruts forming in the ground and once dismantled, leave no trace within the surrounding environment.

orking life
m panels





ROADWAY KIT

The Roadway Kit provides a temporary, aluminium access route for the improved mobility of vehicles, cranes and other wheeled transportation. Comprising of your Trackway® solution of choice, a deployment system to match your budget, and accessories as standard, traversing difficult environments has never been easier.



C90 Trackway®



C40 Trackway®



C20 Trackway®

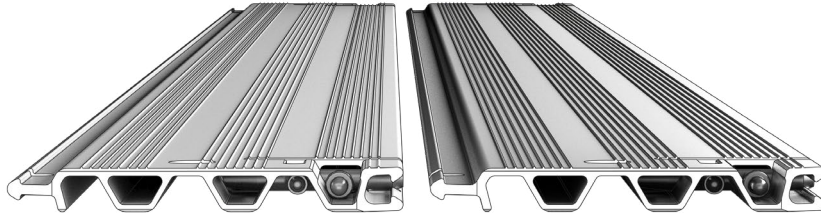

C50 Trackway®



DEPLOYMENT OPTIONS

Our Plant Attachment systems are mounted via a bespoke adapter plate and quick release hydraulic couplings to a compatible Material Handling Equipment host machine.

90PA

The 90PA allows for 30m (98ft) of C90 Trackway® to be deployed in under 5 minutes by 2 individuals.

40PA

Our 40PA will deploy, recover, transport and store up to 40m (131ft) of your C40 Trackway® solution.

20PA

Facilitating rapid deployment and recovery, the 20PA system allows for up to 40m (131ft) of C20 Trackway® solution.



PLAY VIDEO





GROSS WEIGHT
3,650Kg
INCLUDES: DISPENSER WITH
40M OF CLEAN TRACKWAY



FAUN
TRACKWAY USA





PUSHFRAME

By connecting to its host machine with a quick hitch or suitable hitch, the Pushframe is designed to roll out and recover up to 50m (164ft) of C40 or C90 Trackway®.



PUSHBAR

A galvanised steel device that deploys and recovers up to 40m (131ft) of C40 Trackway® or 30m (98ft) of C90 Trackway®.

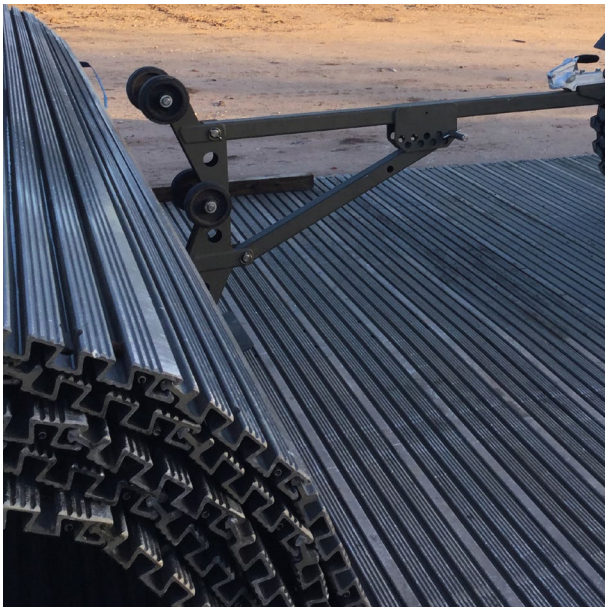

BOAT RAMP KIT

Used as a temporary or more permanent solution, the Boat Ramp Kit can be laid where a conventional boat ramp structure is not suitable; such as tidal areas, freezing waters and marsh.

Getting your ship to shore is quick and effective, with a choice of Trackway® solutions and accompanying deployment systems dependent on your budget and host vehicle.

C40 Trackway®



C90 Trackway®





DEPLOYMENT OPTIONS

PUSHFRAME

Designed to roll out and recover up to 50m (164ft) of C40 or C90 Trackway® rapidly, by use of a compatible host machine with a quick hitch or suitable hitch.

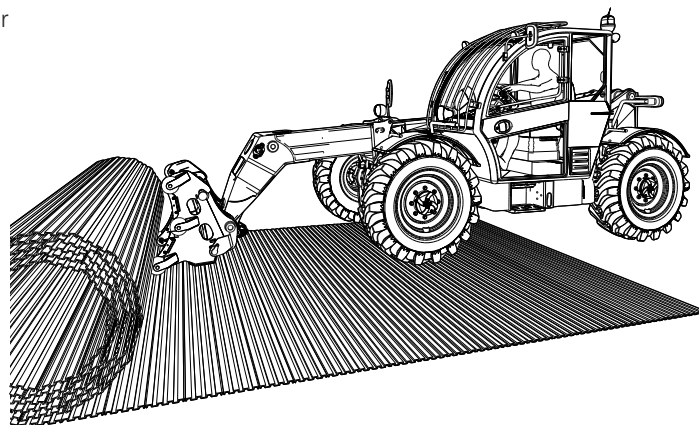

PUSHBAR

With a strong tolerance to sea waters, the Pushbar can deploy up to 40m (131ft) of C40 Trackway® or 30m (98ft) of C90 Trackway® by use of vehicle with a towing capacity of 3,500kg (7,716lb).

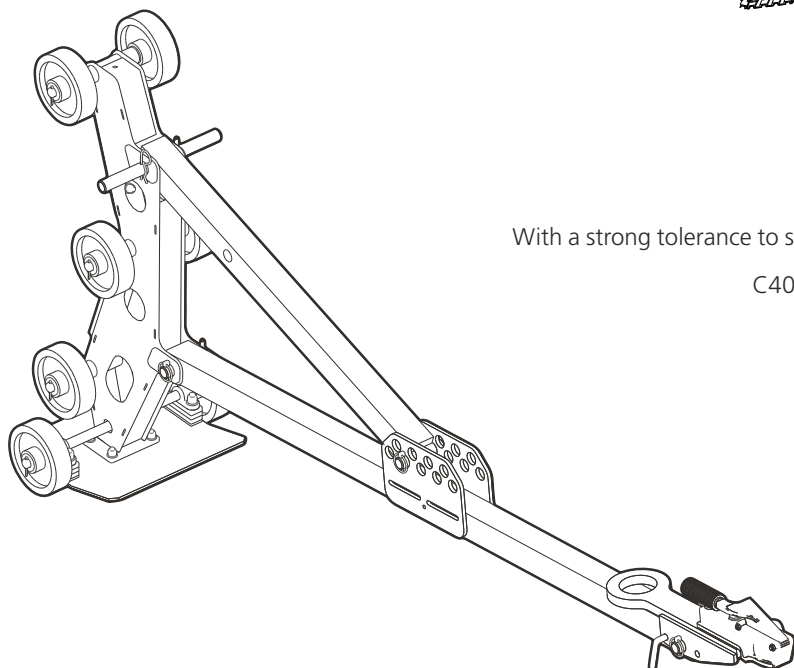

PLAY VIDEO

Parbuckling Strap

The Parbuckling Strap assists in the manual recovery of the Boat Ramp Kit. During deployment the strap is positioned centrally under the Trackway® as it is laid out. On recovery, the end of the Parbuckling Strap is attached to a vehicle's centre tow point.





AIRCRAFT RECOVERY KIT

The Aircraft Recovery Kit facilitates with the recovery of all types of aircraft within an array of operations, terrain and climates. Comprising of a modular, aluminium, panel by panel system, the ground stabilisation solution enables:

1

Quick access roadways for vehicles to reach aircraft that are damaged or have overshoot a runway.

2

Safe walkways for individuals to reach aircraft that are damaged or have overshoot a runway.

3

Area matting to quickly and safely tow aircraft back to a runway.

C50 Trackway®

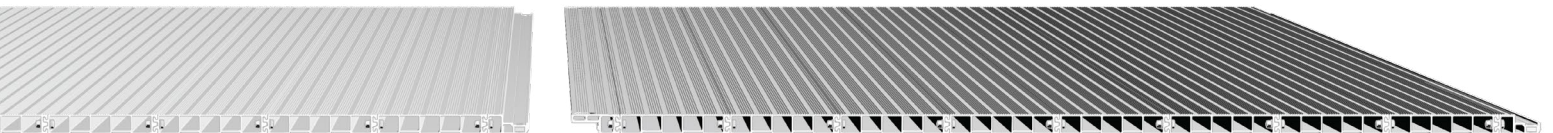

DEPLOYMENT OPTIONS

Manually laid and recovered, the C50 Trackway® panels are connected to one another longitudinally with an overlapped joint and fastened together with a flush bolt. Providing a continuous, trip-free surface, the panels which are laid in a straight configuration are connected horizontally with a connecting bar.

AREA MATS: Full panels in a straight configuration or full and half panels in a brickwork configuration.

WALKWAYS: Full panels in a straight configuration.

ROADWAYS: Full panels in a straight configuration.





TESTIMONIALS

"Build it and they will come. 'The beach starts here' is our motto for a reason, and this innovative solution is certainly testament to that!"

Kingston District Council, SE Australia

"Very pleased with both the product and the service and wouldn't hesitate to recommend FAUN Trackway®."

Williams Jet Tenders, Berinsfield, England

FAUN Trackway® has an excellent product that has proven itself time and again. They went above and beyond to ensure our Boat Ramp Kit got delivered on the opposite side of the world."

Norton Sound Economic Corporation, Alaska, USA





FAUN Trackway Limited

Member of the KIRCHHOFF Group

Unit 6, Bryn Cefni Industrial Estate
Llangefni, Anglesey
North Wales
LL77 7XA, UK

Tel: +44 (0) 1248 722 777
Fax: +44 (0) 1248 750 490

info@fauntrackway.co.uk
www.fauntrackway.co.uk

Images for Illustration Purposes Only

Registered in England and Wales 09283749
All content © FAUN Trackway Limited 2023. All Rights Reserved